

To receive your tohamed® Blood Bag Segment Perforator, please print the following information and fax it to:

Sartorius Stedim Plastics GmbH
Karl-Arnold-Strasse 21
37079 Goettingen, Germany
Phone +49.551.50450.0
Fax +49.551.50450.50
www.sartorius-stedim.com/tohamed

Sartorius Stedim Plastics GmbH
+49.551.50450.50

Name

Title

Company

Street

City | St. | Zip

E-Mail

Sartorius Stedim Plastics GmbH
Karl-Arnold-Strasse 21
37079 Goettingen, Germany
Phone +49.551.50450.0
Fax +49.551.50450.50
www.sartorius-stedim.com/tohamed

tohamed®
Blood Bag Segment Perforator





tohamed® Blood Bag Segment Perforator

The Affordable Solution
for More Safety

Benefits

- Save
- Reliable
- Easy to use

We would like to present a product to you that makes work in your cross-match lab faster, safer and a lot easier.

The tohamed® blood bag segment perforator enhances user safety and is therefore the ideal solution for taking samples from bag segments.

The tohamed® segment perforator reduces the risk of injury and effectively prevents the user from coming into contact with blood.

Ordering Information

Blood Bag Segment Perforator
Order no. TH 1702
4 x 250 pcs./box



As simple as 1-2-3-4-5

tohamed® Blood Bag Perforator

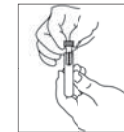

1 | Insert segment opener into a test tube with 9 to 10 mm diameter.

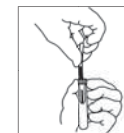

2 | Jointly fixate tube and opener. Insert donor segment. Always insert end with red cell layer if the blood in the segment has settled. Ensure that welded flag of the segment is smoothly gliding in the side cavities of the opener.

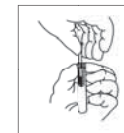

3 | Push donor segment down with a quick but gentle motion, until the piercing needle completely enters the segment.

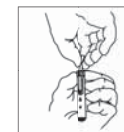

4 | Gently squeeze the protruding part of the segment to release blood into the tube. Too much force may cause hemolysis of the red blood cells.

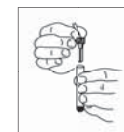

5 | Release pressure on the segment. Remaining blood in the needle will be drawn back and dripping prevented.

Dispose segment and opener into container for hazardous medical waste.